

**SPECIFICATIONS**

Current Rating:9 AMPS Per Circuit Max.  
 Voltage Rating:600V R.M.S.  
 Dielectric Withstanding:1500V AC R.M.S.  
 For One Minute  
 Contact Resistance:10 Milliohms Max.  
 Insulation Resistance:1000 Megohms Min.  
 At DC 1000V  
 Operating Temperature:-40°C~+105°C  
 Insulator: Nylon 66  
 Contact:Brass  
 Tin Plated

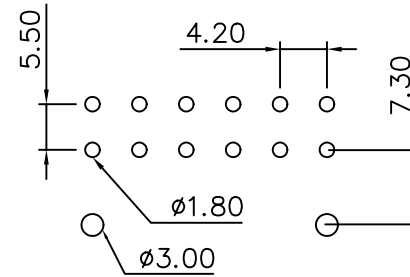

Recommended P.C.Board Layout

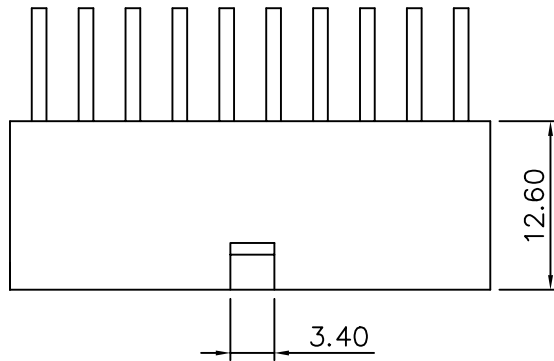
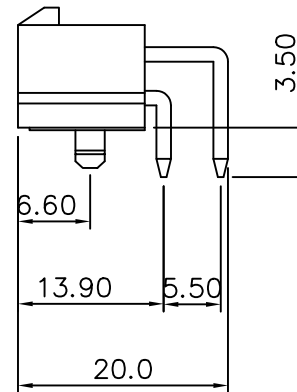
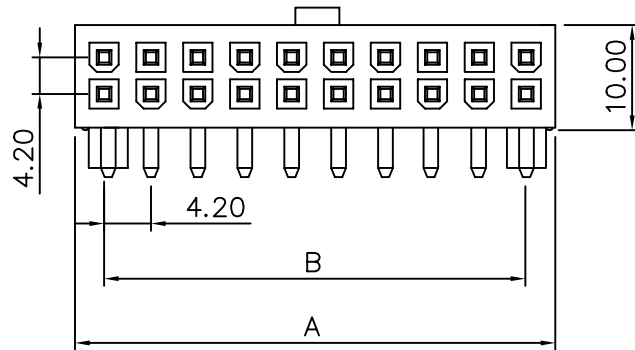

Position	A	B
2	5.40	--
4	9.60	4.20
6	13.90	8.40
8	18.10	12.60
10	22.30	16.80
12	26.50	21.00
14	30.80	25.20
16	35.00	29.40
18	39.20	33.60
20	43.40	37.80
22	47.60	42.00
24	51.80	46.20

**4UCON** 元化興業股份有限公司  
 4UCON TECHNOLOGY INC.

DRAWING No.  
 07821

APPROVED BY MEI  
 CHECKED BY BECKY  
 DRAWING BY HZF

UNLESS OTHERWISE SPECIFIED TOLERANCES ARE  
 .X ±0.38  
 .XX ±0.25  
 .XXX

SCALE NONE

REV. A0

UNIT mm

NO. REV.

NEW RELEASE REVISIONS

MEI CHK DATE