

Model 400 Round Short Tail

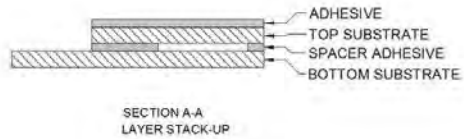

Exploded View

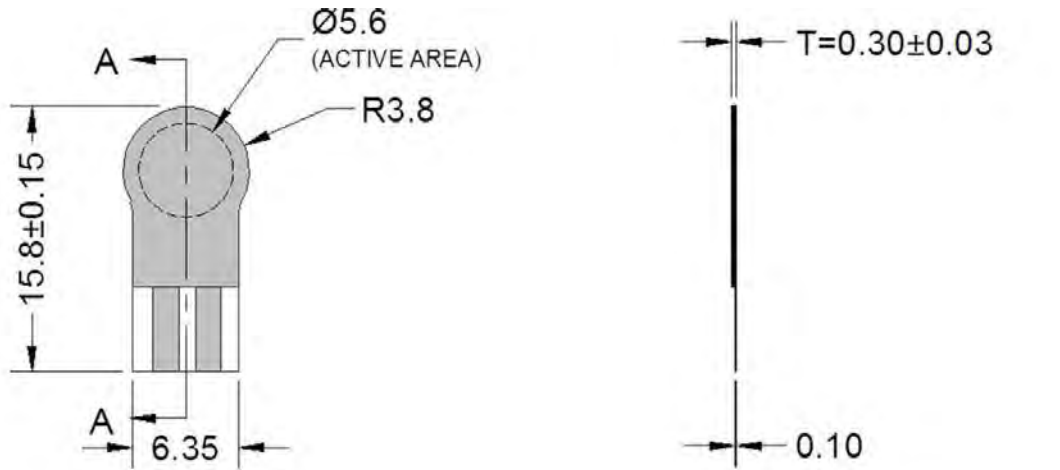
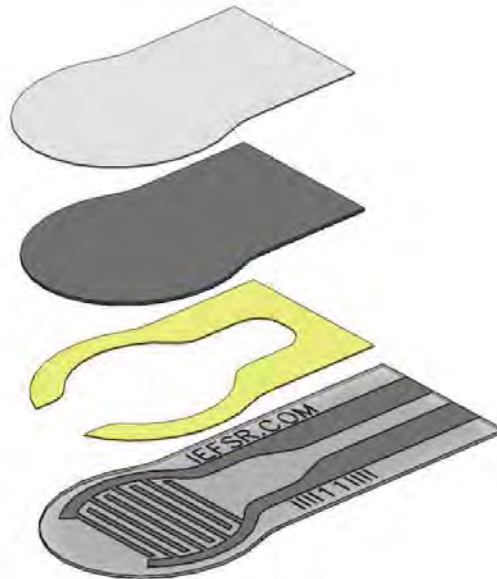
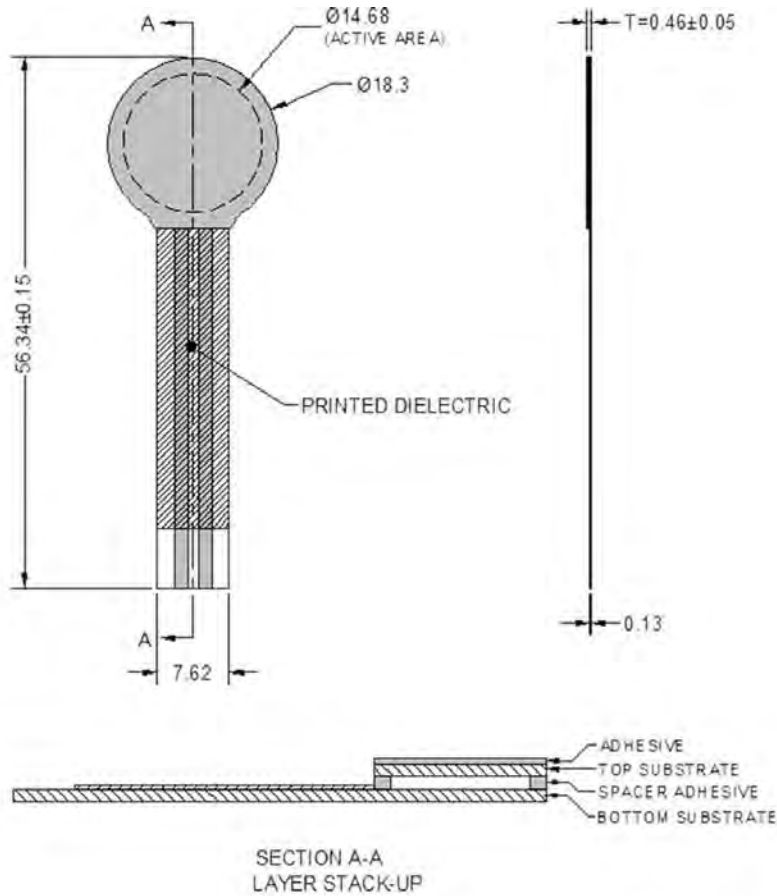

Figure 5: Model 400 Short Tail Round FSR

Model 402 Round

Measurements: millimeters



Exploded View

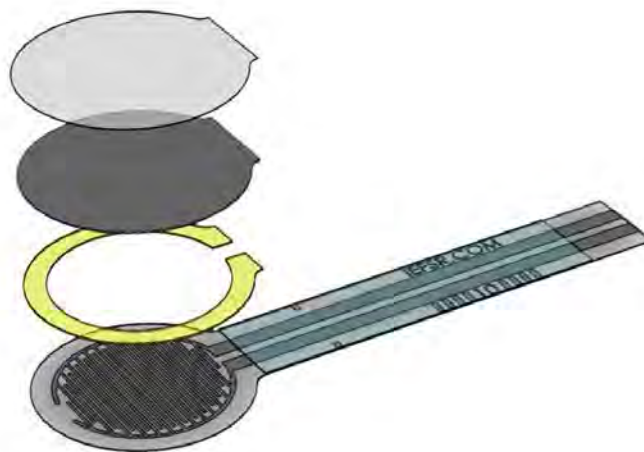
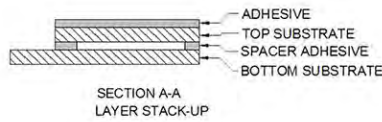
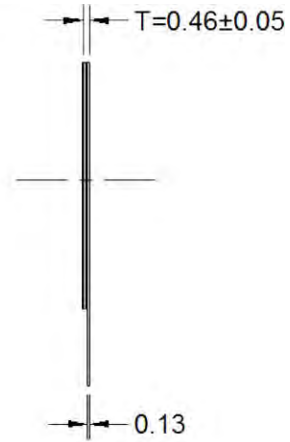
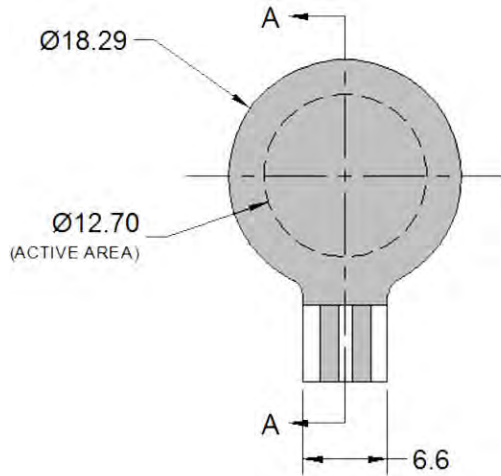

Figure 6: Model 402 Short Tail Round FSR

Model 402 Round Short Tail

Measurements: millimeters



Exploded View

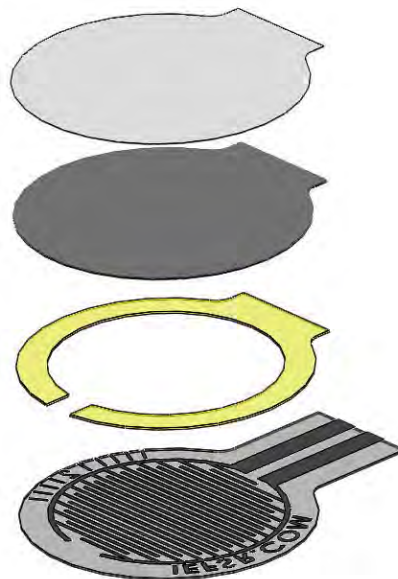
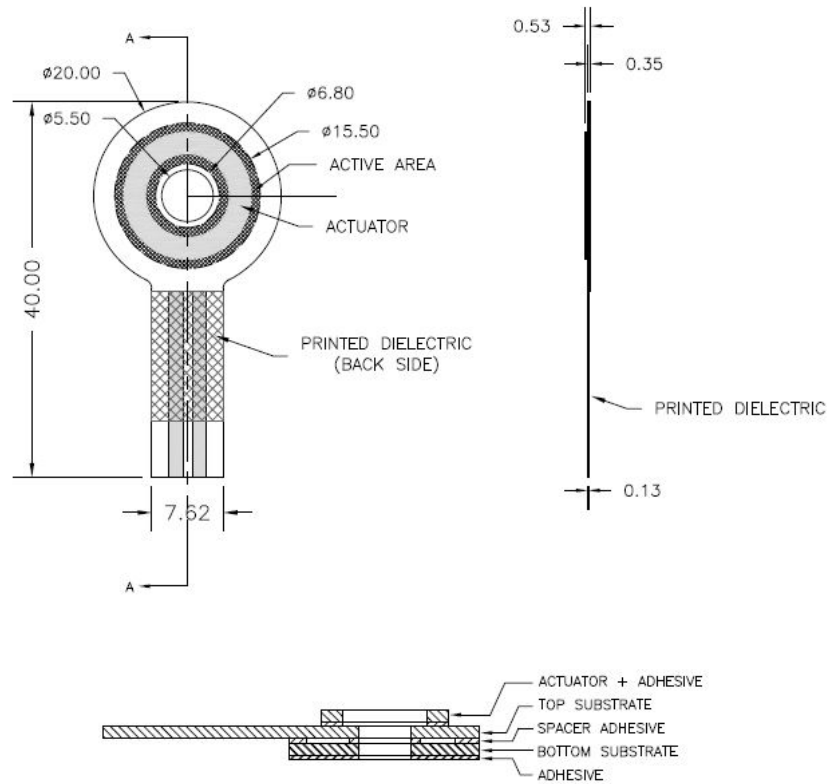

Figure 7: Model 402 Short Tail Round FSR

Model 404 Single Zone Donut

Measurements: millimeters



Exploded View

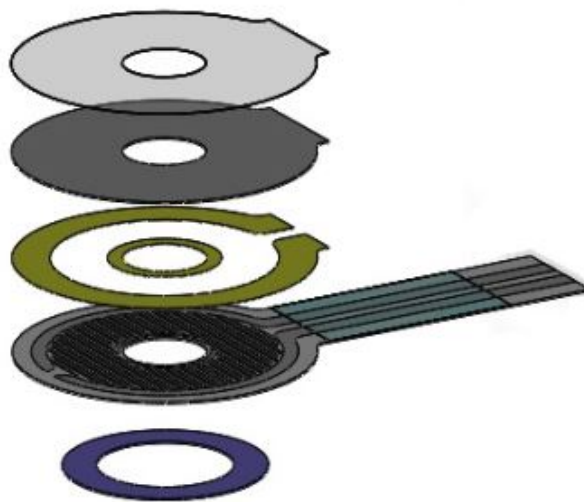
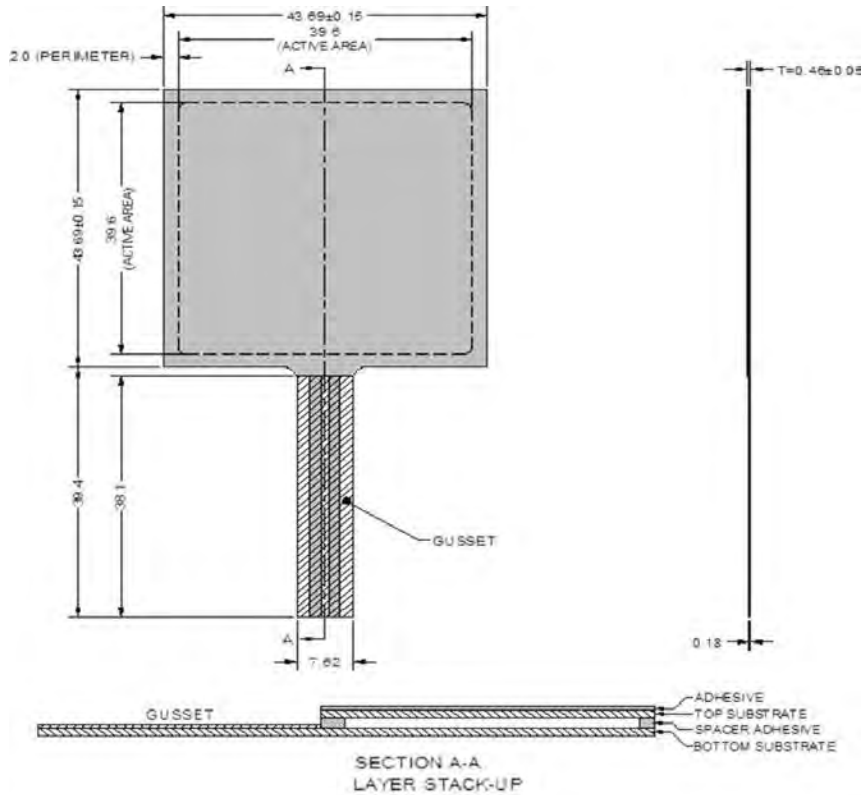

Figure 8: Model 404 Single Zone Donut FSR

The standard Model 406 (Figure 8) square FSR, as compared to the round FSR, offers similar functionality within a larger electrically active area.

Model 406 Square

Measurements: millimeters



Exploded View

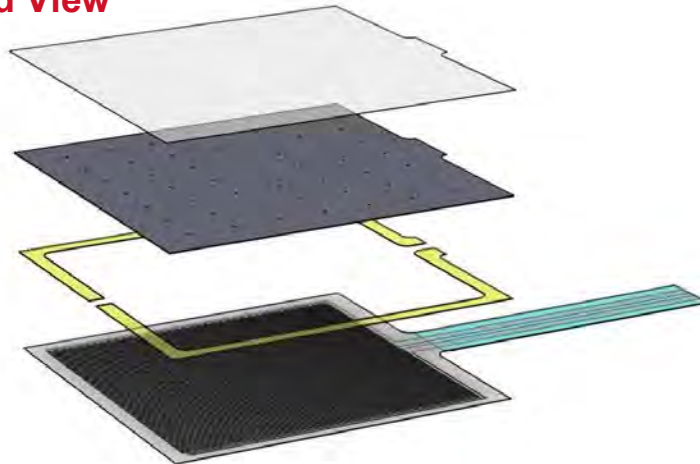
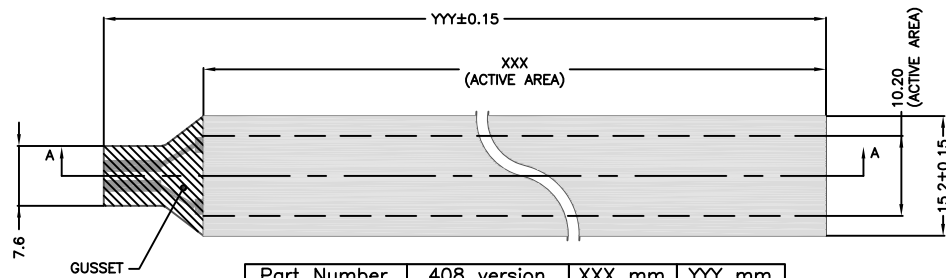

Figure 9: Model 406 Square FSR

The standard Model 408 (Figure 9) strip FSR is useful for force detection in large devices.

Model 408 Strip: Ua Jm

Measurements: millimeters



Part Number	408 version	XXX mm	YYY mm
34-00068	408-50	50.00	62.70
34-00069	408-100	100.00	112.70
34-00070	408-200	200.00	212.70
34-00071	408-300	300.00	312.70
34-00072	408-400	400.00	412.70
34-00073	408-500	500.00	512.70
30-61710	408	609.60	622.30

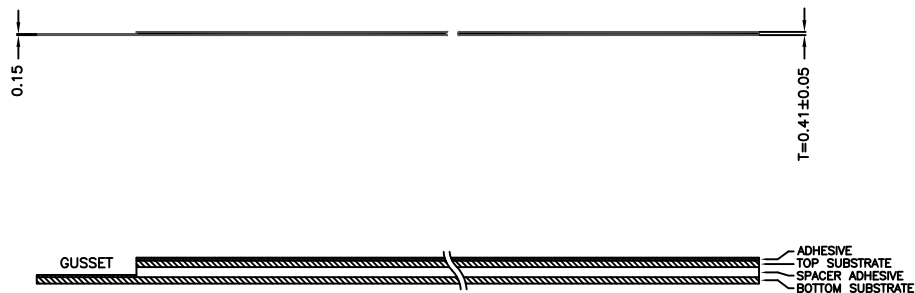

SECTION A-A
LAYERS STACK-UP

Exploded View

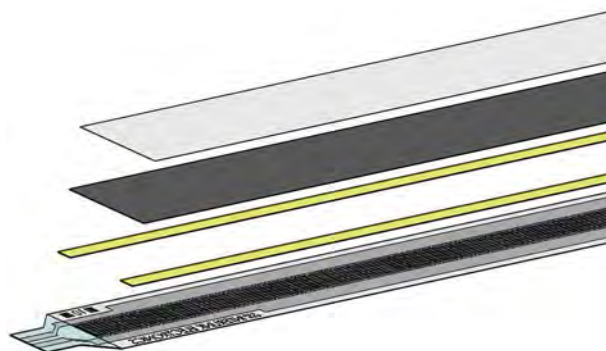

Figure 10: Model 408 Strip FSR

