

## Datasheet of Hanging Load Cell

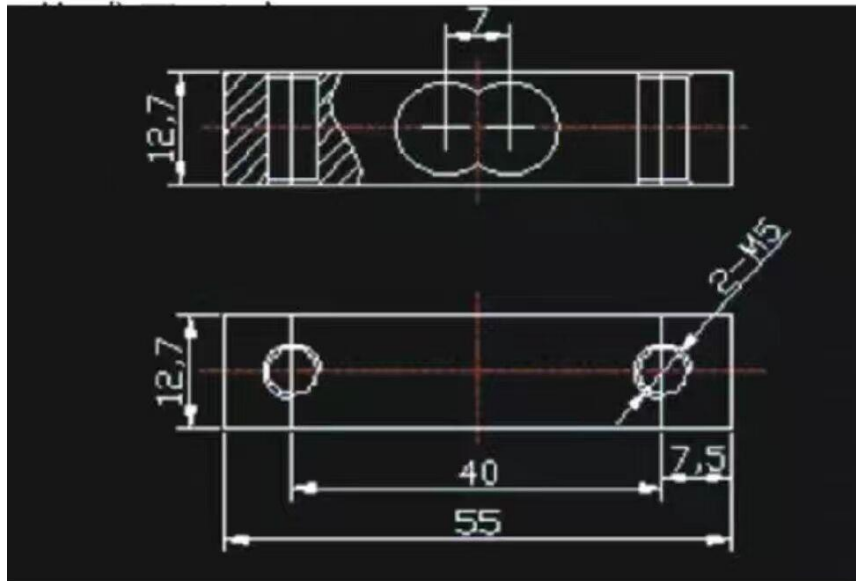

Comprehensive Accuracy	(%F.S)	0.05
Load (Capacity)	(kg)	10
Output Sensitivity	(mV/V)	1.0±0.1
Zero Output	(mV/V)	±0.1
Nonlinearity	(%F.S)	0.05
Repeatability	(%F.S)	0.05
Hysteresis	(%F.S)	0.05
Creep	(%F.S/3 min)	0.05
Zero Drift	(%F.S/1 min)	0.05
Temp. Effect on Zero	(%F.S/10°C)	0.2
Temp. Effect on Span	(%F.S/10°C)	<0.15
Input Resistance	(Ω)	1000±50
Output Resistance	(Ω)	1000±50
Insulation Resistance	(MΩ 100VDC)	≥2000
Excitation Voltage	(V)	3-12
Operating Temperature	(°C)	-10 to +50
Ultimate Overload	(%F.S)	150